

CBR TABLE

CBR	6F2 CAPPING THICKNESS
1	600MM (SEE SECTION)
2	450MM
3	375MM
4	300MM
<5	250MM
>5	NONE REQUIRED

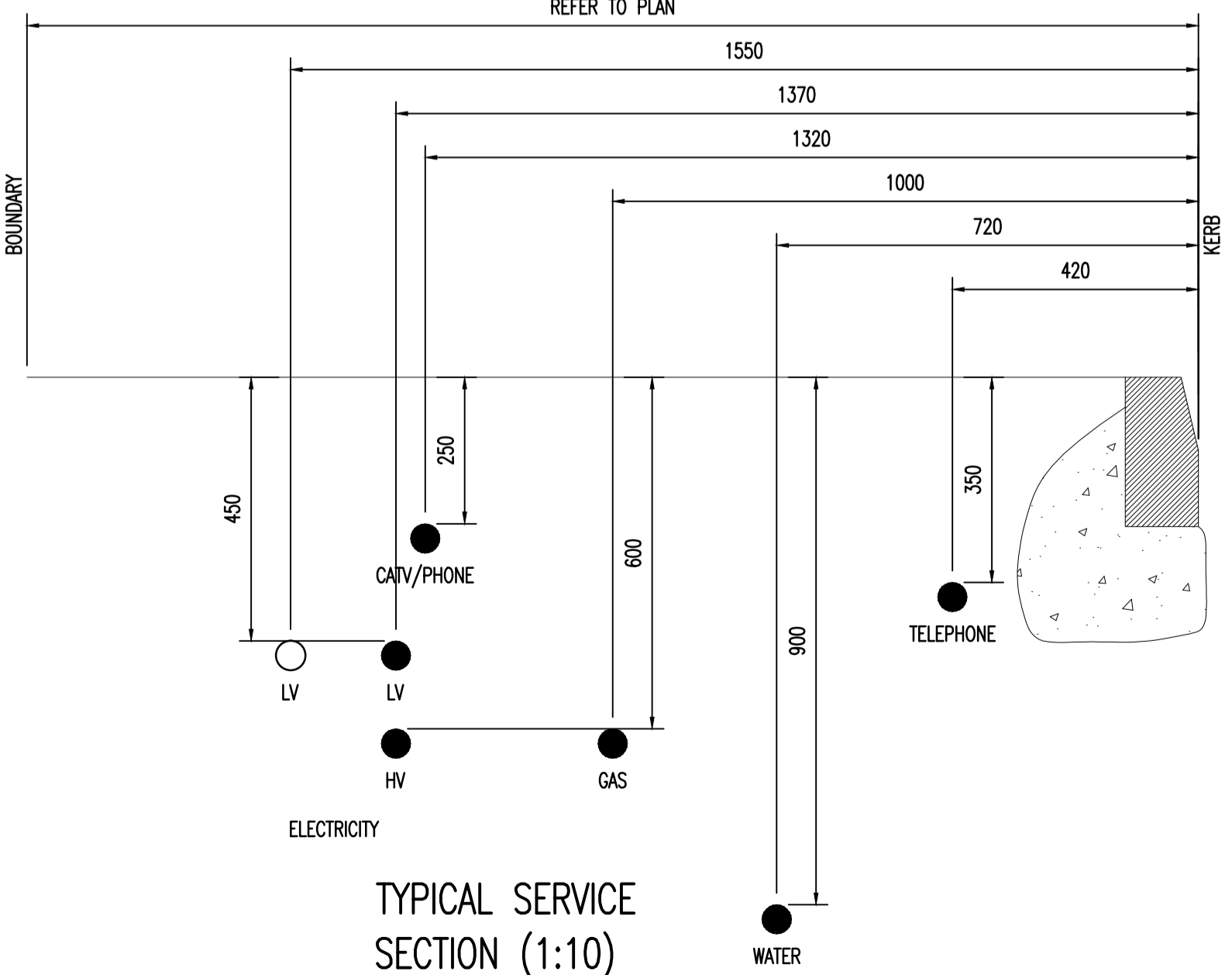
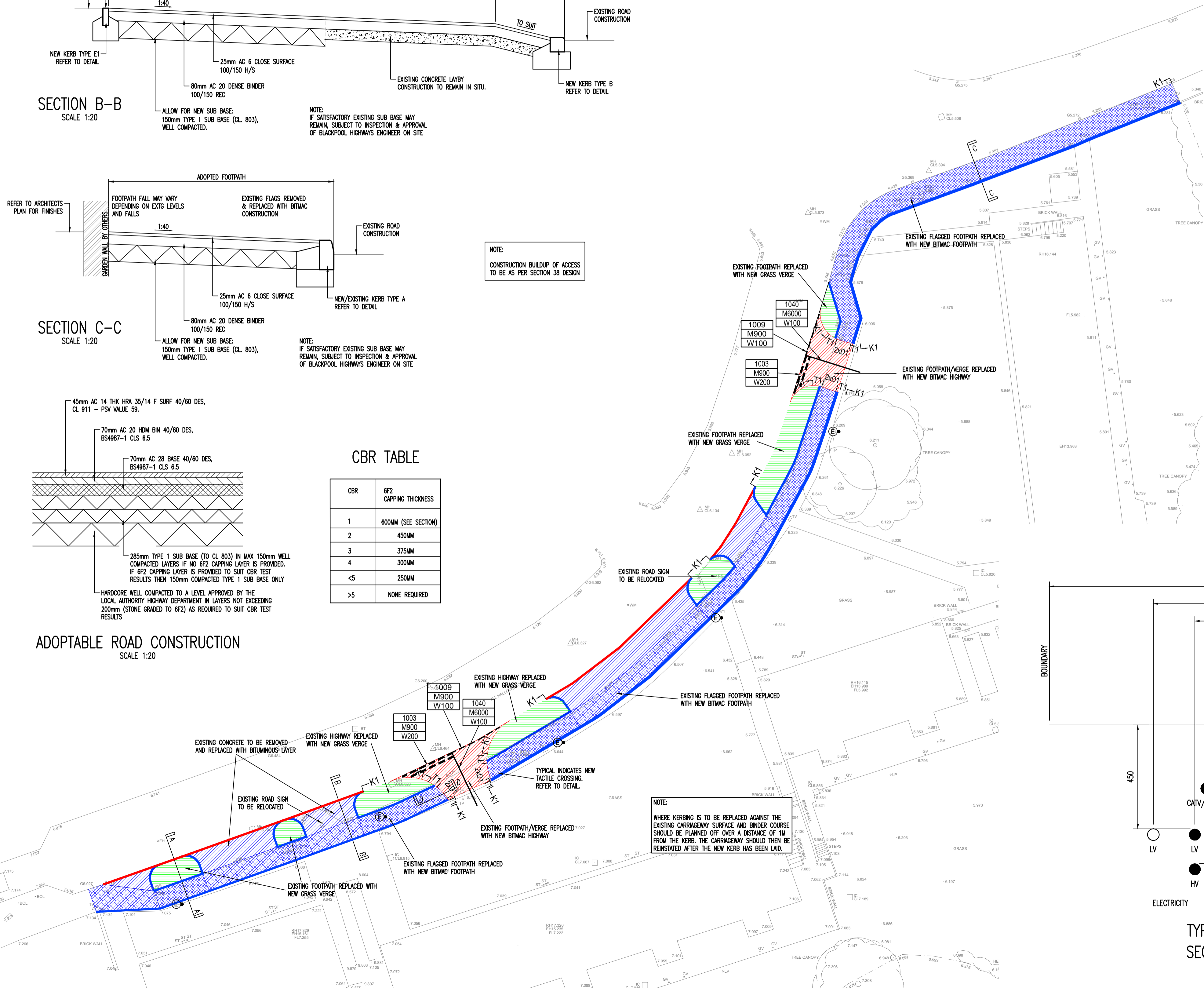
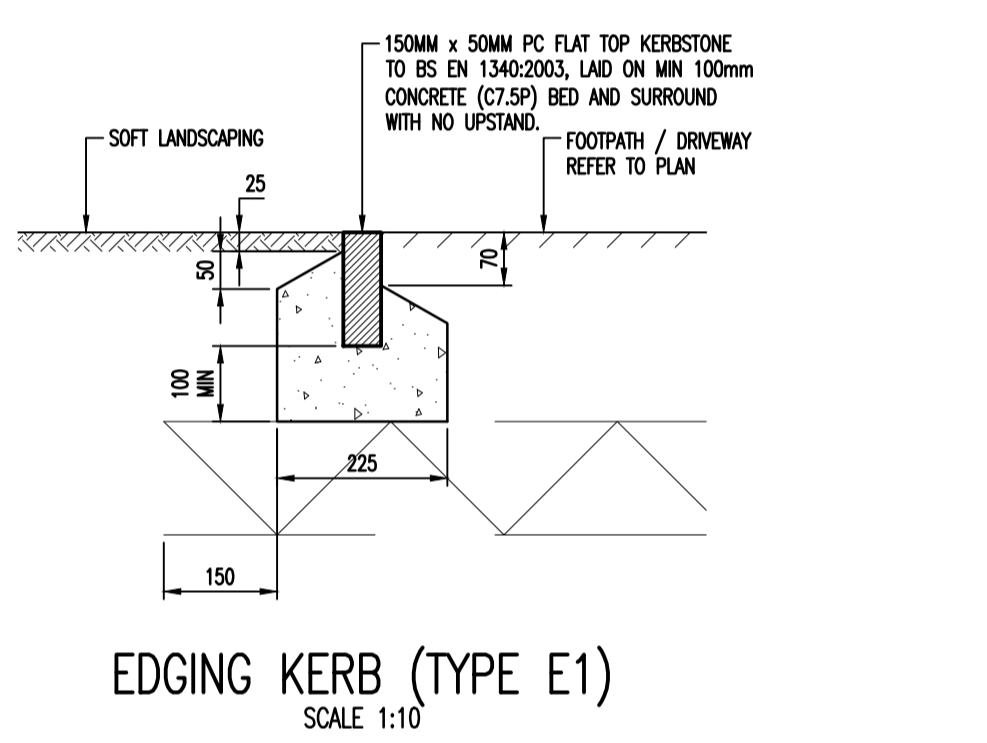
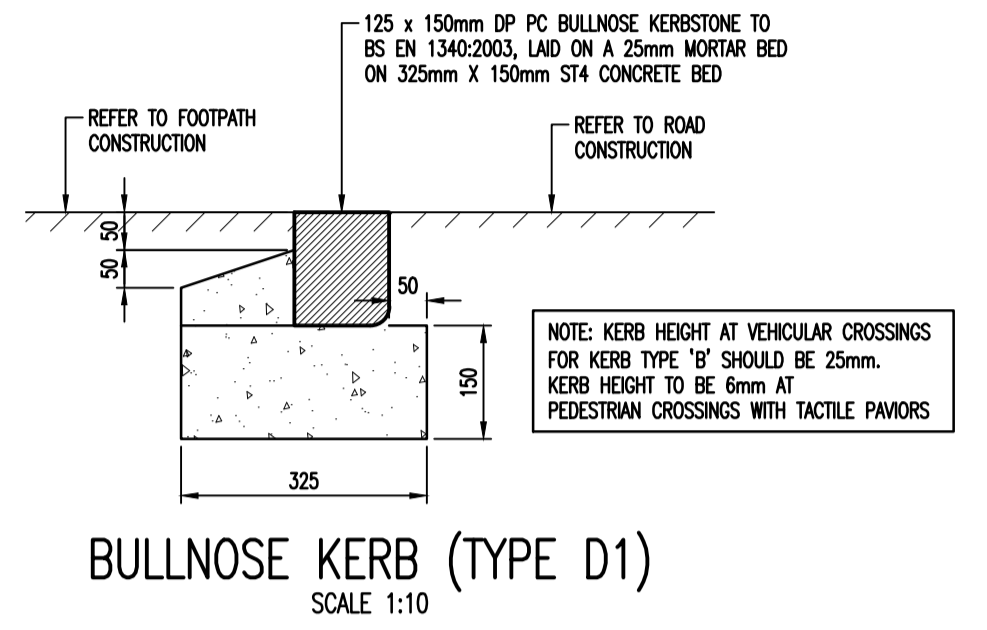
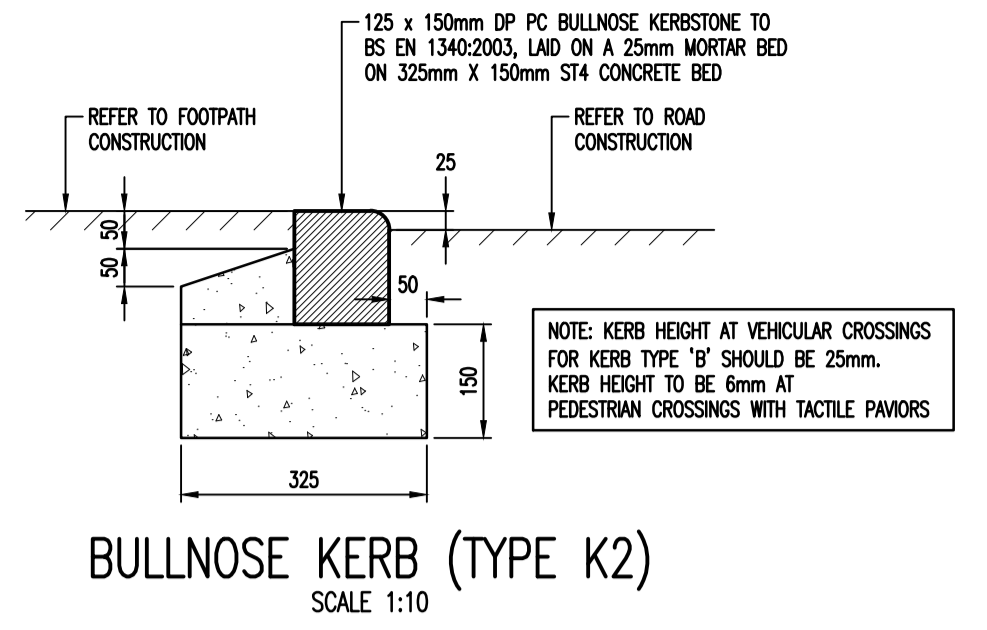
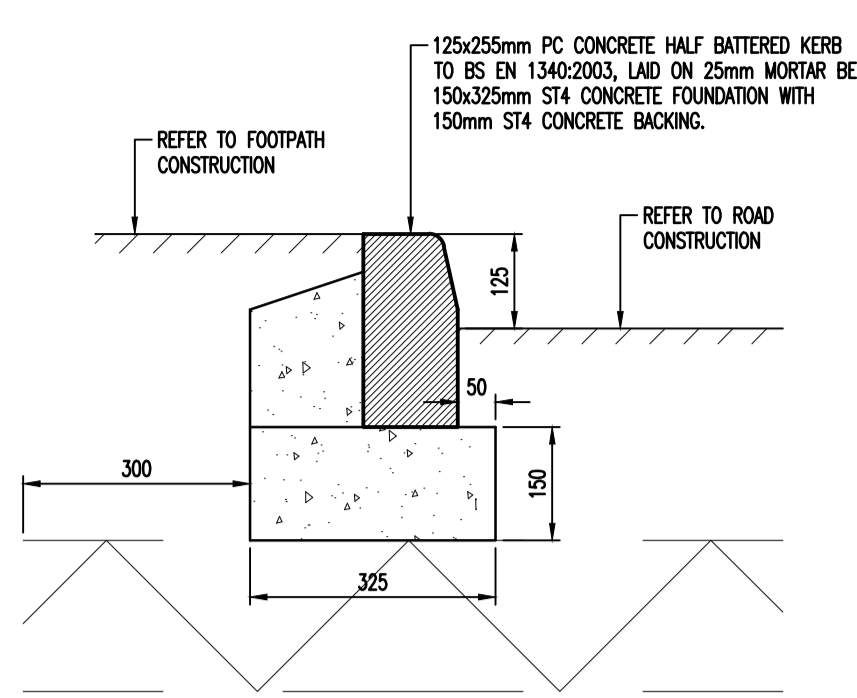

DO NOT SCALE OFF THIS DRAWING

GENERAL NOTES

This drawing to read in conjunction with all relevant structural and architectural drawings and specifications.

All dimensions to be checked on site by the contractor / fabricator prior to commencement of works.

All dimensions are in millimetres unless stated otherwise.

All works to be carried out in strict accordance with the engineer's specifications, relevant British Standards and where applicable Local Authorities requirements.

For final setting out information relating to grid lines and wall positions refer to the architect's drawings.

- SURFACING KEY:-**
- EXISTING FLAGGED FOOTPATH REPLACED WITH NEW BITMAC FOOTPATH
 - EXISTING BITMAC HIGHWAY TO REMAIN
 - NEW BITMAC FOOTPATH
 - EXISTING FOOTPATH REPLACED WITH NEW GRASS VERGE
 - EXISTING FOOTPATH/VERGE REPLACED WITH NEW BITMAC HIGHWAY
- ⊙ DENOTES EXISTING LIGHTING COLUMN TO BE REMOVED AND RELOCATED
- ⊙ DENOTES PROPOSED NEW LIGHTING COLUMN POSITION

- KERBING KEY:-**
- K1 = PRECAST FULL HEIGHT CONCRETE HALF BATTER KERB WITH 125mm UPSTAND (TO BE INSTALLED AS PER DETAIL)
 - K2 = PRECAST FULL HEIGHT CONCRETE BULL NOSED WITH 25mm UPSTAND (TO BE INSTALLED AS PER DETAIL)
 - D1 = PRECAST CONCRETE DROPPED BULL NOSED WITH 0mm UPSTAND (TO BE INSTALLED AS PER DETAIL)
 - T1 = TRANSITION FROM HALF BATTER KERB WITH 125mm TO A DROPPED BULL NOSE WITH 0mm UPSTAND (TO BE INSTALLED AS PER DETAIL)
 - T2 = TRANSITION FROM HALF BATTER KERB WITH 125mm UPSTAND TO A DROPPED BULL NOSE WITH 25mm UPSTAND (TO BE INSTALLED AS PER DETAIL)

- ROAD MARKINGS:-**
- 1004: DIMENSION NO. (TRAFFIC SIGNS REGULATIONS & GENERAL DIRECTIONS 2002)
 - M6000: TOTAL LENGTH OF MODULE (mm) - SEE NOTE 4
 - W100: WIDTH (mm)
- NOTES:-**
- THIS DRAWING SHOULD BE READ IN CONJUNCTION WITH ALL OTHER DETAILED DESIGN DRAWINGS AND THE MANCHESTER STREETSCAPE MANUAL.
 - ALL ROAD MARKINGS AND TRAFFIC SIGNS TO BE IN ACCORDANCE WITH THE TRAFFIC SIGNS REGULATIONS AND GENERAL DIRECTIONS (2002) AND THE TRAFFIC SIGNS MANUAL.
 - ANY EXISTING ROAD SIGNS TO BE RELOCATED AS PART OF THE WORKS MUST BE POSITIONED BY A BLACKPOOL COUNCIL ENGINEER TO ENSURE THEY MEET THE TRAFFIC SIGNS REGULATIONS RELATING TO THE SPEED REGULATING SCHEME ON ALL MAIN ROAD.
 - THE SCHEME WILL REQUIRE SOME DOUBLE YELLOW LINES FOR JUNCTION PROTECTION. THIS WILL BE ARRANGED BY BLACKPOOL COUNCIL AND INCLUDED IN THE 278 FEE AGREEMENT.

Rev	Date	Checked	Description	By
B	30.03.16	D.S	NOTE ADDED	EJC
A	25.02.16	D.S	CONSTRUCTION ISSUE	AJB

CONSTRUCTION

18-20 Harrington Street, Liverpool L2 9QA
t: 0151 227 3155 f: 0151 227 3156
e: sutcliffe@sutcliffe.co.uk w: www.sutcliffe.co.uk

Client: **GREAT PLACES**

Project: **ALL HALLOWS ROAD BLACKPOOL**

Drawing title: **SECTION 278 WORKS**

Scale at A1	1:250	Drawing number	27541-652
Drawn by	EJC	Revision suffix	B
Date	JULY 2015		